

**DM30**  
For 2" to 6" Lines

The DM30 is a great mid-range pipe snake that cleans through the big sewer pipes just as easily small drains. Use this sewer snake for residential, floor drains, roof vents or light commercial jobs.



**Specifications:**

- 1/2 HP motor
- 200 RPM

**Features:**

- Power Cable Feed and Return
- Telescoping Handle
- Ground Fault Circuit Interruptor
- Standard Safety Air Foot Pedal
- 10" Wide Wheels
- Available with 19" or 21" reels



**Snake Specifications (estimated)**

<b>Length</b>	
With wheels (standard)	40-1/2"
<b>Width</b>	
With wheels (standard)	24-3/4"
<b>Height</b>	
With wheels (standard)	20"
<b>Weight</b>	
Machine	100 lbs.
Reel (DIJ1-standard)	21 lbs.
PCFR	12 lbs.
Wheels (wide), 10"	12 lbs.
<b>Arms</b>	
D8K6S	21" Metal,
	19" Polyethylene/Metal
61RAS	21" Polyethylene

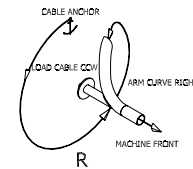

This is the standard arm that comes with this machine package.

The DM30 drain snake features a double-tube frame for added stability when on the job. The electrical wiring of this machine runs through the top of the frame so normal wear will not expose the wiring. This machine can run several different sized reels which makes this machine very versatile with the flexibility of the cable diameter and length.

DM30	
Item	Item Description
<b>Metal Reel Packages</b>	
DM30 SP	1/2 HP motor at 200 RPM with PCFR, 21" open spoke metal reel, 5/8" x 100' cable
DM30 SP-1	1/2 HP motor at 200 RPM without PCFR, 21" open spoke metal reel, 5/8" x 100' cable
DM30 SPE	1/2 HP motor at 200 RPM with PCFR, 21" enclosed metal reel, 5/8" x 100' cable
DM30 SP-1E	1/2 HP motor at 200 RPM without PCFR, 21" enclosed metal reel, 5/8" x 100' cable
DM30 SPA	1/2 HP motor at 200 RPM with PCFR, 19" open spoke metal reel, 1/2" x 100' cable
DM30 SPA-1	1/2 HP motor at 200 RPM without PCFR, 19" open spoke metal reel, 1/2" x 100' cable
DM30 SPEA	1/2 HP motor at 200 RPM with PCFR, 19" enclosed metal reel, 1/2" x 100' cable
DM30 SPEA-1	1/2 HP motor at 200 RPM without PCFR, 19" enclosed metal reel, 1/2" x 100' cable
<b>Polyethylene Reel Packages</b>	
DM30 SPB	1/2 HP motor, 200 RPM with PCFR, 21" polyethylene reel, 5/8" x 100' cable
DM30 SPB-1	1/2 HP motor, 200 RPM without PCFR, 21" polyethylene reel, 5/8" x 100' cable
DM30 SPC	1/2 HP motor, 200 RPM with PCFR, 19" polyethylene reel, 1/2" x 100' cable
DM30 SPC-1	1/2 HP motor, 200 RPM without PCFR, 19" polyethylene reel, 1/2" x 100' cable

CABLE SUBSTITUTIONS	
Item	Item Description
CH50-100	1/2" x 100' Hollow Core
LC	Cable Pre-Loaded into Reel
<b>ACCESSORIES / REPLACEMENT PARTS</b>	
Item	Item Description
DRC19	Reel Cover for 19" Open Spoke Metal Reel (DIS1)
DRC21	Reel Cover for 21" Open Spoke Metal Reel Cover (DIJ1)
DKIT2	Blade Kit
PCFR	Power Cable Feed and Return
PCFR80K	Power Cable Feed and Return Adapter Kit
WWK10	Wide Wheels
NWK10	Narrow Wheels
61005K	1/2 HP Motor
61052K	Stair Guide Kit
PCFR35K	Guide Tube (use with PCFR)

# DM30 Pipe Snake

25010K - SWITCH PLATE ASSY.

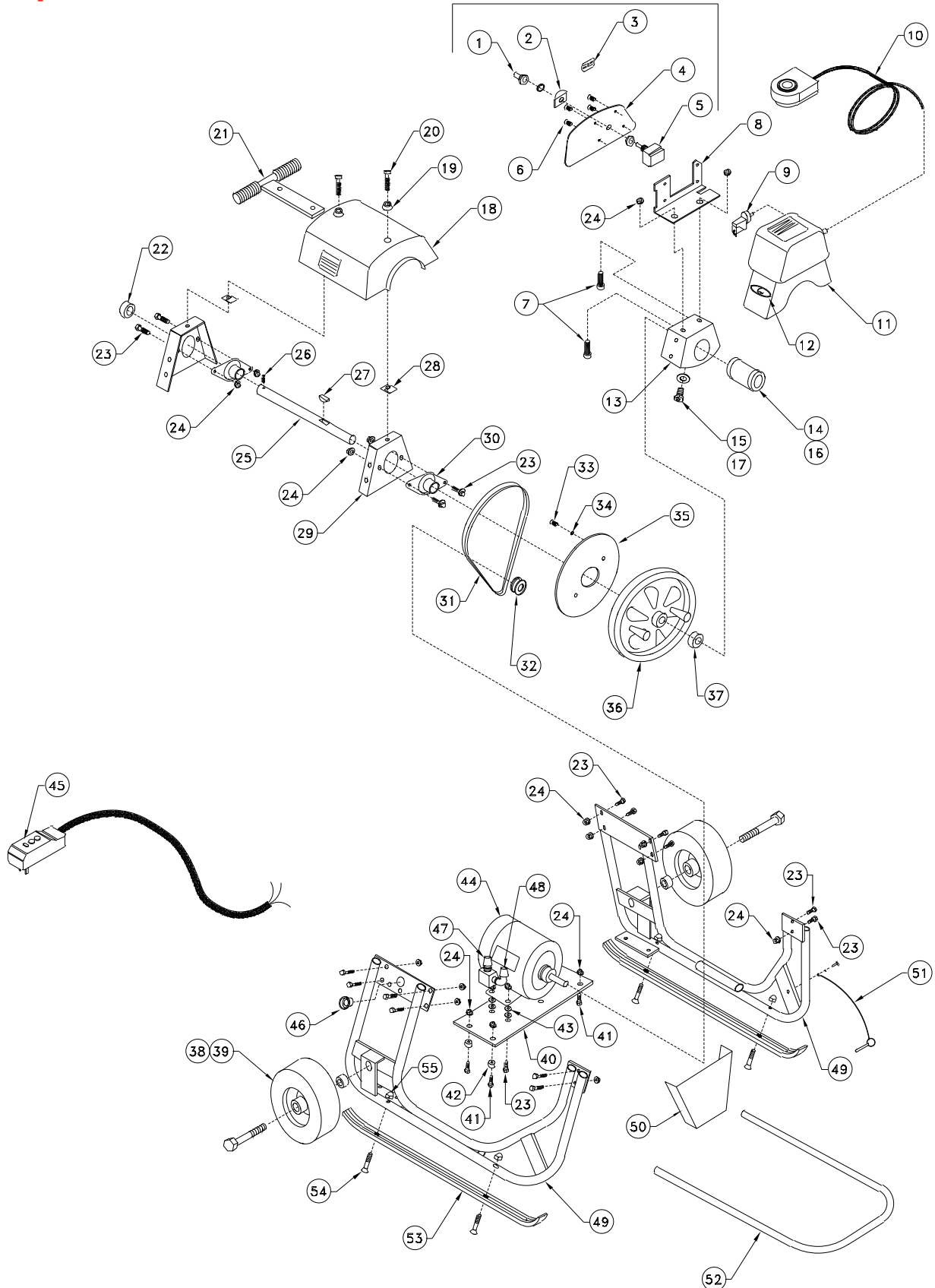

**DM30 Pipe Snake**



The entire line item in **bold** identifies the name of an entire assembly. The "Z" shaped arrow identifies all the parts that make up that assembly. You can purchase the entire assembly, or just the individual parts.







DM30 PARTS LIST			
Item#	Qty.	Part#	Description
<b>1</b>	1	25010K	Switch Plate Assembly
1	1	ECT26	Rubber Switch Boot
2	1	25015	Switch Guard
3	1	25065	Decal, Forward/Off/Reverse
4	1	25010	Switch Plate
5	1	25005	Detent Switch, Wired with Jumpers
6	4	PHSC14	#10-24" x 1/2" Pan Head Machine Screw
7	2	SHCS11	5/16"-18 x 1" Socket Head Cap Screw
8	1	25115	Switch Bracket
9	1	25060	Air Foot On/Off Switch
<b>10</b>	1	25073K	Foot Pedal Assembly
	1	25073	Foot Pedal with 8' Tube, Metal Housing
	1	HCL8	Clamp, Constant Tension
<b>11</b>	1	25020K	Switch Housing Assembly with Decals
	1	25020	Switch Housing
	1	25015	Switch Guard
	1	25067	Decal, Foot Switch Danger
12	2	D25000	Decal, Machine Logo
13	1	25100	Head Casting
14	1	25106	Head Bearing, Nylatron Assembly
15	1	SHCS15	3/8"-16 x 3/4" Socket Head Cap Screw
	1	WA10	3/8" Split Lock Washer
16	1	25105	Head Bearing, Steel
17	1	25110	Grease Fitting
	1	CXA	Adapter
	1	ZERK2	1/4"-28 Straight Grease Zerk
	1	WA12	13/32" x 13/16" x 1/16" Zinc Flat Washer
<b>18</b>	1	25030K	Top Cover with Decals
	1	25030	Top Cover
	1	25063	Decal, Guard Danger
	1	25066	Decal, Step Warning
	1	25068	Decal, Electrical Danger
19	2	25130	Bushing, Top Cover
20	2	SHCS11A	5/16"-18 x 1-1/4" Socket Cap Head Screw
21	1	25050	Vertical Support with Grips
	2	PH-1G	Handle Grip, Black
22	1	25125	Collar, Reel Shaft

DM30 PARTS LIST			
Item#	Qty.	Part#	Description
23	20	FLSC1	5/16"-18 x 3/4" Hex Head Flange Screw
24	24	FLNUT3	5/16"-18 Hex Flange Nut, Locking
25	1	25140	Shaft, Reel
26	1	FILHMS1	#10-24 x 3/8" Fillister Machine Screw
27	1	KEY6	1/4" x 1/37" Square Key
	1	KEY2	1/4" x 3/4" Woodruff Key (Old Style)
28	2	C L P - NUT1	5/16"-18 Clip Nut
29	2	25095	Mounting Plate, Bearing
30	2	SB5	Bearing, Reel Shaft
31	1	61010C	Belt, 4L x 44
32	1	25085	Sheave, 4L x 1-3/4" outside diameter
33	6	PHSC12	#10-24 x 3/8" Pan Head Machine Screw
34	6	WA5	#10 External Tooth Lock Washer
35	1	61008	Guard, Sheave
<b>36</b>	1	61010B	Sheave, 4L x 13-1/4" outside dia. assy.
	2	25090	Drive Lug Assembly
	1	25090A	Drive Lug
	1	MM4	Drive Lug Cap, Red
	1	WA10	3/8" Split Lock Washer
37	1	25120	Bushing, Reel Shaft
38	1	NWK10	Narrow Wheel Kit
	2	JWKN	Wheel, 10" Narrow Solid
	2	HHCS27	3/4"-10 x 5" Hex Head Cap Screw
	2	HXNUT17	3/4"-10 Hex Nut
	2	WA18	Bushing, Narrow Wheel
	2	CPSS3	1/4" - 20 x 1/4" Cup Point Set Screw
<b>39</b>	1	WWK10	Wide Wheel Kit
	2	JWKW	Wheel, 10" Wide Semi-Pneumatic
	2	HHCS28	3/4"-10 x 6" Hex Head Cap Screw
	2	HXNUT17	3/4"-10 Hex Nut
	2	25145	Bushing, Wide Wheel
	2	CPSS3	1/4" - 20 x 1/4" Cup Point Set Screw
40	1	61030	Mounting Plate, Motor
41	4	FLSC9	5/16" -18 x 1" Hex Head Flange Screw

# DM30 Pipe Snake



The entire line item in **bold** identifies the name of an entire assembly.  
 The "Z" shaped arrow identifies all the parts that make up that assembly.  
 You can purchase the entire assembly, or just the individual parts.

DM30 PARTS LIST			
Item#	Qty.	Part#	Description
42	4	61044	Stand-Off, Motor Plate
43	8	WA15	1/3" x 3/4" x .07" Stainless Steel Flat Washer
44	1	61005	Motor, 1/2 HP
45	1	25165	GFCI Cord
46	1	ECT34	Strain Relief, 90 degree Snap Elbow
	1	ELN1	1/2"-14 NPT (National Pipe Thread) Lock Nut
47	1	ECT30	1/2" Strain Relief, Straight
	1	ELN1	1/2"-14 NPT Lock Nut
48	1	ECT34	1/2" Strain Relief, 90 degree Snap Elbow
	1	ELN1	1/2" -14 NPT (National Pipe Thread) Lock Nut
49	1	D61015	Frame Set: Right & Left Frame Painted
50	1	61009	Guard, Motor
51	1	MM14	Detent Ring Pin with Lanyard Attached
	1	WA5	#10 External Tooth Lock Washer
	1	PHSC14	#10-24 x 1/2" Pan Head Machine Screw
52	1	61025	Handle Assembly
	2	RLPIN12	3/8" diameter x 1-3/8" Roll Pin
53	2	61050	Reinforcement Strip
54	4	FHMS5	5/16"-18 x 1-1/2" Flat Head Machine Screw
55	4	HXNUT9	5/16"-18 Hex Acorn Nut

## Wide Wheel Mounting Instructions (DM55, DM30)

1. Insert axle (1) through wheel (2).
2. Place wheel bushing (3) onto axle between the wheel and axle support (as shown).
3. Pass axle assembly through hole in axle support (old style only).
4. Thread axle nut (4) to axle after it has passed through axle support (old style only).
5. Thread axle to axle hub. Tighten until wheel is secure yet free-spinning.
6. Over-tightening of the axle will damage the wheel bearing.
7. Axle nut must be backed off as the axle is being tightened (old style only).
8. Tighten axle nut to the axle hub to secure axle.
9. Tighten set screw in axle hub to secure axle.
10. Repeat process on other side of machine.

PARTS LIST			
Item#	Qty.	Part#	Description
SETSCREW	2	CPSS3	1/4 – 20 X .25 Skt HD Set Screw
4	2	HXNUT 17	3/4 – 10 Hex Nut
3	2	25145	Wheel Bushing
2	2	JWKW	Wide Wheel – 10" dia.
1	2	HHCS28	3/4 – 10 x 6.00 Hex HD Cap Screw

### Tools:

Axle – 1-1/8" Socket and Open End Wrench  
 Set Screw – 1/8" Hex Key or Allen Wrench

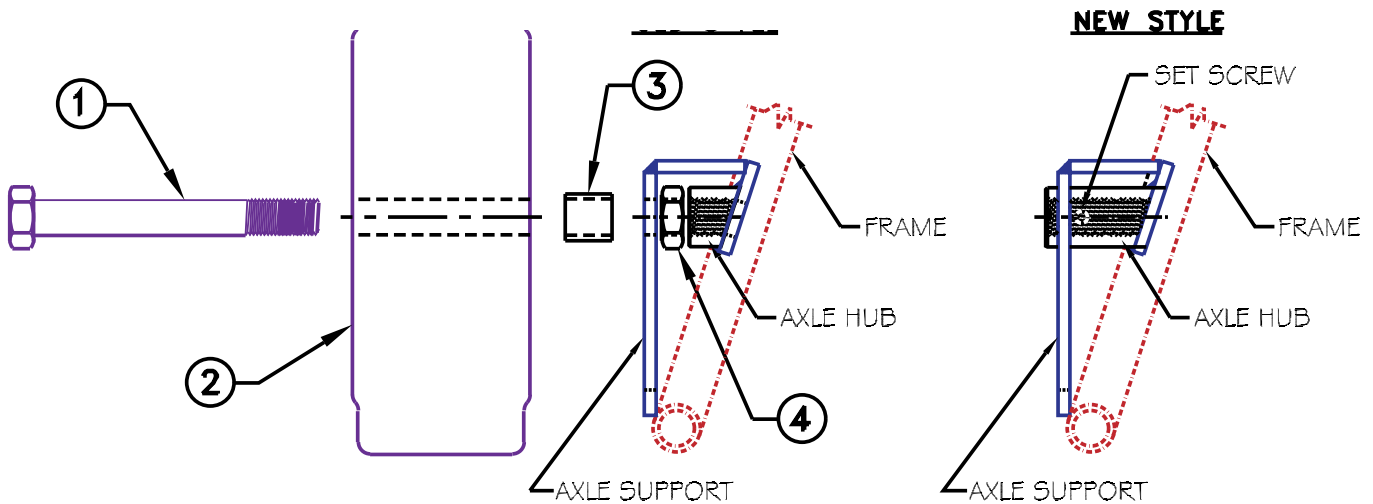

## Narrow Wheel Mounting Instructions (DM55, DM30)

1. Insert axle (1) through wheel (2).
2. Place wheel bushing (3) onto axle between the wheel and axle support (as shown).
3. Pass axle assembly through hole in axle support (old style only).
4. Thread axle nut (4) to axle after it has passed through axle support (old style only).
5. Thread axle to axle hub. Tighten until wheel is secure yet free-spinning.
6. Over-tightening of the axle will damage the wheel bearing.
7. Axle nut must be backed off as the axle is being tightened (old style only).
8. Tighten axle nut to the axle hub to secure axle.
9. Tighten set screw in axle hub to secure axle.
10. Repeat process on other side of machine.

PARTS LIST			
Item#	Qty.	Part#	Description
SETSCREW	2	CPSS3	1/4 – 20 X .25 Skt HD Set Screw
4	2	HXNUT 17	3/4 – 10 Hex Nut
3	2	WA18	Wheel Bushing
2	2	JWKN	Narrow Wheel – 10" dia.
1	2	HHCS27	3/4 – 10 x 5.00 Hex HD Cap Screw

### Tools:

Axle – 1-1/8" Socket and Open End Wrench  
Set Screw – 1/8" Hex Key or Allen Wrench

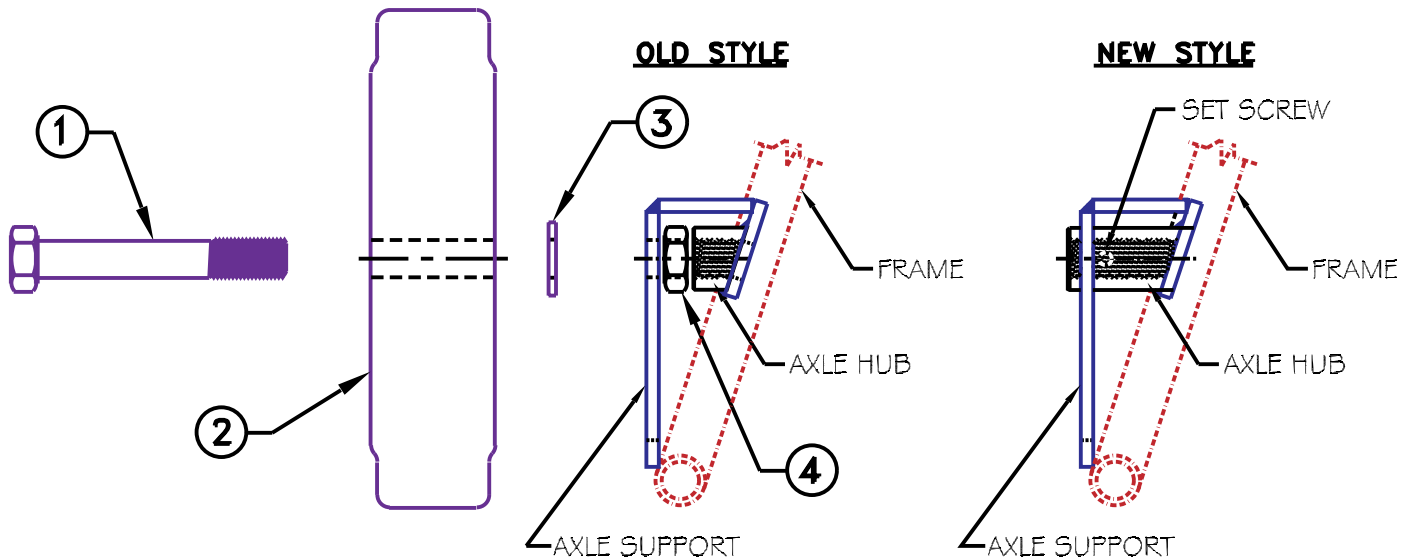

## Mounting Instructions for Sheave Disc (DM30, DM30, J-Maxx)

1. Disconnect power supply to machine.
2. Loosen motor mounting screws.
3. Remove drive belt and real sheave from machine.
4. Unscrew and remove drive-lugs on front side of sheave. Remove drive-lug cap prior to unscrewing or tightening the drive-lug.
5. Center disc on the back side of sheave, align the disc mounting holes with the tapped holes on the sheave.
6. Use the drive-lugs to secure the disc to the back side of the sheave.
7. Use the disc as a templat to mark hole locations on the sheave spokes.
8. Remove the drive-lugs and the disc.
9. Drill ( $0.156$ ) and tap ( $\#10-24$ ) the six (6) mounting holes as marked.
10. Use the screws and washers provided to secure the disc to the sheave.
11. Install the drive-lugs and capes on front side of sheave.
12. Install drive belt and sheave in reverse order of removal.
13. Adjust belt tension as needed and refasten motor mounting screws.

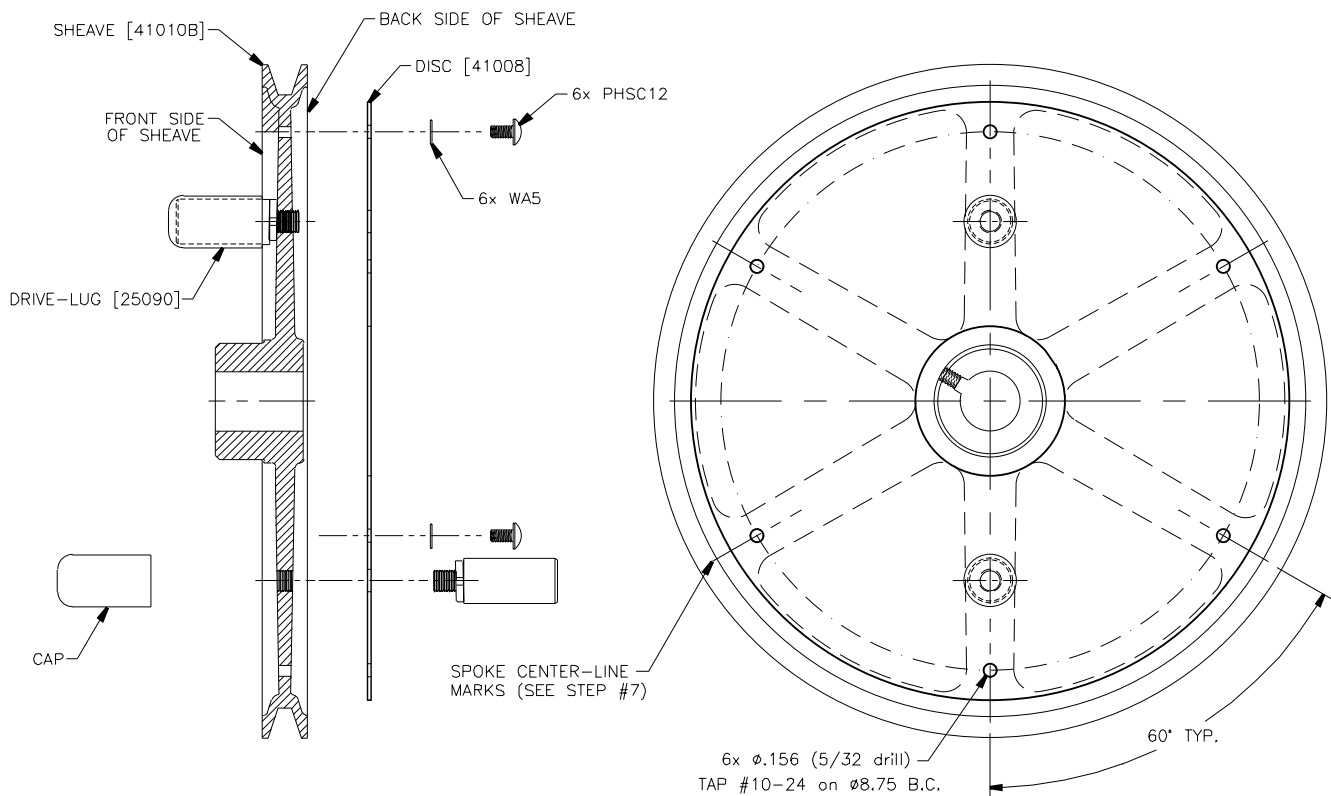

## Mounting Instructions for Sheave Guard (DM30, DM30, J-Maxx)

1. Disconnect power supply to machine.
2. Place the machine in the upright position and remove the reel.
3. Loosen the front two (2) motor nuts, securing the motor bolts to the motor mounting plate, about 1/4" (as shown).
4. \*Slide the sheave guard between the front two (2) motor nuts and the motor mounting plate, leaving a 1/8" gap between the motor shaft and the sheave guard (refer to print).
5. Hold sheave guard in position and tighten the front two (2) motor nuts until sheave guard is secure.
6. Reattach reel and check for clearance, reel should rotate freely.
7. If rubbing occurs, adjust sheave guard as necessary.
8. Repeat steps #6 and #7 until all reels spin freely.

*\*Note: The sheave guard can be mounted as shown or mounted on the bottom side of the motor plate.*

